

Pressure and vacuum gauges

Pressure gauges

## Pressure gauge DN 63 vertical connection with glycerin (1/4" BSP)

Page: 1/2

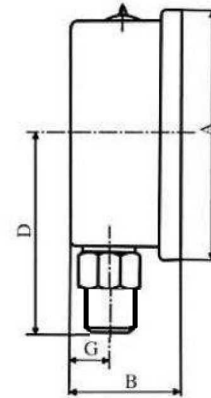
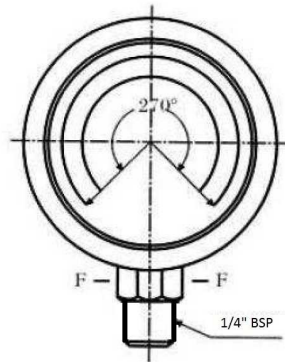

**Accuracy:** 1,6%

**Dimensions:** A=68  
B=29,8  
D=54,5  
F=HEX 14  
G=9,5

**Temperature:** from -20 up to +60

**Material:** Case: stainless steel 304  
Ring: stainless steel 304  
Window: polycarbonate (glass)  
Socket & Connection: brass

Part n°	R1	Scale (bar)
<b>MFI6304001V</b>	1/4" BSP	0-1
<b>MFI63042.5V</b>	1/4" BSP	0-2.5
<b>MFI6304004V</b>	1/4" BSP	0-4
<b>MFI6304006V</b>	1/4" BSP	0-6
<b>MFI6304010V</b>	1/4" BSP	0-10
<b>MFI6304012V</b>	1/4" BSP	0-12
<b>MFI6304016V</b>	1/4" BSP	0-16
<b>MFI6304020V</b>	1/4" BSP	0-20
<b>MFI6304025V</b>	1/4" BSP	0-25
<b>MFI6304040V</b>	1/4" BSP	0-40
<b>MFI6304060V</b>	1/4" BSP	0-60
<b>MFI6304100V</b>	1/4" BSP	0-100
<b>MFI6304160V</b>	1/4" BSP	0-160

Pressure and vacuum gauges

Pressure gauges

## Pressure gauge DN 63 vertical connection with glycerin (1/4" BSP)

Page: 2/2

Part n°	R1	Scale (bar)
<b>MFI6304250V</b>	1/4" BSP	0-250
<b>MFI6304315V</b>	1/4" BSP	0-315
<b>MFI6304400V</b>	1/4" BSP	0-400
<b>MFI6304600V</b>	1/4" BSP	0-600
<b>MFI63041000V</b>	1/4" BSP	0-1000

\*\*\* Review attached PDF\*\*\*

With dual bar/psi scale